



HEARING NOTICE

LAND USE REQUEST AFFECTING THIS AREA

Audiencia Pública

Si necesita ayuda para comprender esta informacion, por favor llame 503-588-6173

| | |
|-----------------------------------|---|
| CASE NUMBER: | Historic Design Review Case No. HIS19-30 |
| AMANDA APPLICATION NO: | 19-115690-DR |
| HEARING INFORMATION: | <u>Historic Landmarks Commission, Thursday, September 19, 2019, 5:30 P.M., Council Chambers, Room 240, Civic Center, 555 Liberty Street SE, Salem, OR 97301</u> |
| PROPERTY LOCATION: | 787 Cross St SE, Salem OR 97302 |
| OWNER / APPLICANT: | Tom Andersen |
| DESCRIPTION OF REQUEST: | <p>Summary: A proposal to install solar panels on the roof of the Custer and Virginia Ross House (1934).</p> <p>Request: Major Historic Design Review of a proposal to install solar panels on the southern portion of the roof of the Custer and Virginia Ross House (1934), a historic contributing resource within the Gaiety Hill/Bush's Pasture Park Historic District, located at 787 Cross Street SE (Marion County Tax Assessor's Number 073W34AB01100).</p> |
| CRITERIA TO BE CONSIDERED: | <p>MAJOR HISTORIC DESIGN REVIEW</p> <p>General Guidelines for Historic Contributing Resources</p> <p>Pursuant to SRC 230.065, an application for a Major Historic Design Review proposing changes to a contributing building or structure may be approved if the proposal conforms to the following guidelines:</p> <ul style="list-style-type: none">(a) Except as otherwise provided in this Chapter, the property shall be used for its historic purpose, or for a similar purpose that will not alter street access, landscape design, entrance(s), height, footprint, fenestration, or massing.(b) Historic materials, finishes and distinctive features shall, when possible, be preserved and repaired according to historic preservation methods, rather than restored.(c) Distinctive stylistic features or examples of skilled craftsmanship significance shall be treated with sensitivity.(d) Historic features shall be restored or reconstructed only when supported by physical or photographic evidence.(e) Changes that have taken place to a historic resource over the course of time are evidence of the history and development of a historic resource and its environment, and should be recognized and respected. These changes may have acquired significance in their own right, and this significance should be recognized and respected.(f) Additions and alterations to a historic resource shall be designed and constructed to minimize changes to the historic resource.(g) Additions and alterations shall be constructed with the least possible loss of historic materials and so that significant features are not obscured, damaged, or destroyed.(h) Structural deficiencies in a historic resource shall be corrected without visually |

changing the composition, design, texture or other visual qualities.

(i) Excavation or re-grading shall not be allowed adjacent to or within the site of a historic resource which could cause the foundation to settle, shift, or fail, or have a similar effect on adjacent historic resources.

HOW TO PROVIDE TESTIMONY:

Any person wishing to speak either for or against the proposed request may do so in person or by representative at the Public Hearing. Written comments may also be submitted at the Public Hearing. Include case number with the written comments. Prior to the Public Hearing, written comments may be filed with the Salem Planning Division, Community Development Department, 555 Liberty Street SE, Room 305, Salem, Oregon 97301. Only those participating at the hearing, in person or by submission of written testimony, have the right to appeal the decision.

HEARING PROCEDURE:

The hearing will be conducted with the staff presentation first, followed by the applicant's case, neighborhood organization comments, testimony of persons in favor or opposition, and rebuttal by the applicant, if necessary. The applicant has the burden of proof to show that the approval criteria can be satisfied by the facts. Opponents may rebut the applicant's testimony by showing alternative facts or by showing that the evidence submitted does not satisfy the approval criteria. Any participant may request an opportunity to present additional evidence or testimony regarding the application. A ruling will then be made to either continue the Public Hearing to another date or leave the record open to receive additional written testimony.

Failure to raise an issue in person or by letter prior to the close of the Public Hearing with sufficient specificity to provide the opportunity to respond to the issue, precludes appeal to the Land Use Board of Appeals (LUBA) on this issue. A similar failure to raise constitutional issues relating to proposed conditions of approval precludes an action for damages in circuit court.

Following the close of the Public Hearing a decision will be issued and mailed to the applicant, property owner, affected neighborhood association, anyone who participated in the hearing, either in person or in writing, and anyone who requested to receive notice of the decision.

CASE MANAGER:

Hayley Feightner, Planner I, City of Salem Planning Division, 555 Liberty Street SE, Room 305, Salem, Oregon 97301. Telephone: 503-540-2315; E-mail: hfeighner@cityofsalem.net.

NEIGHBORHOOD ORGANIZATION:

South Central Association of Neighbors (SCAN), Jon Christenson, Historic Design Review Land Use Chair; Email: edscannewsletter@gmail.com.

DOCUMENTATION AND STAFF REPORT:

Copies of the application, all documents and evidence submitted by the applicant are available for inspection at no cost at the Planning Division office, City Hall, 555 Liberty Street SE, Room 305, during regular business hours. Copies can be obtained at a reasonable cost. The Staff Report will be available seven (7) days prior to the hearing, and will thereafter be posted on the Community Development website:

<https://www.cityofsalem.net/Pages/planning-notices-decisions.aspx>

ACCESS:

The Americans with Disabilities Act (ADA) accommodations will be provided on request.

NOTICE MAILING DATE:

August 29, 2019

PLEASE PROMPTLY FORWARD A COPY OF THIS NOTICE TO ANY OTHER OWNER, TENANT OR LESSEE.

For more information about Planning in Salem:

<http://www.cityofsalem.net/planning>

\\Allcity\amanda\AmandaForms\4430Type3-4HearingNotice.doc





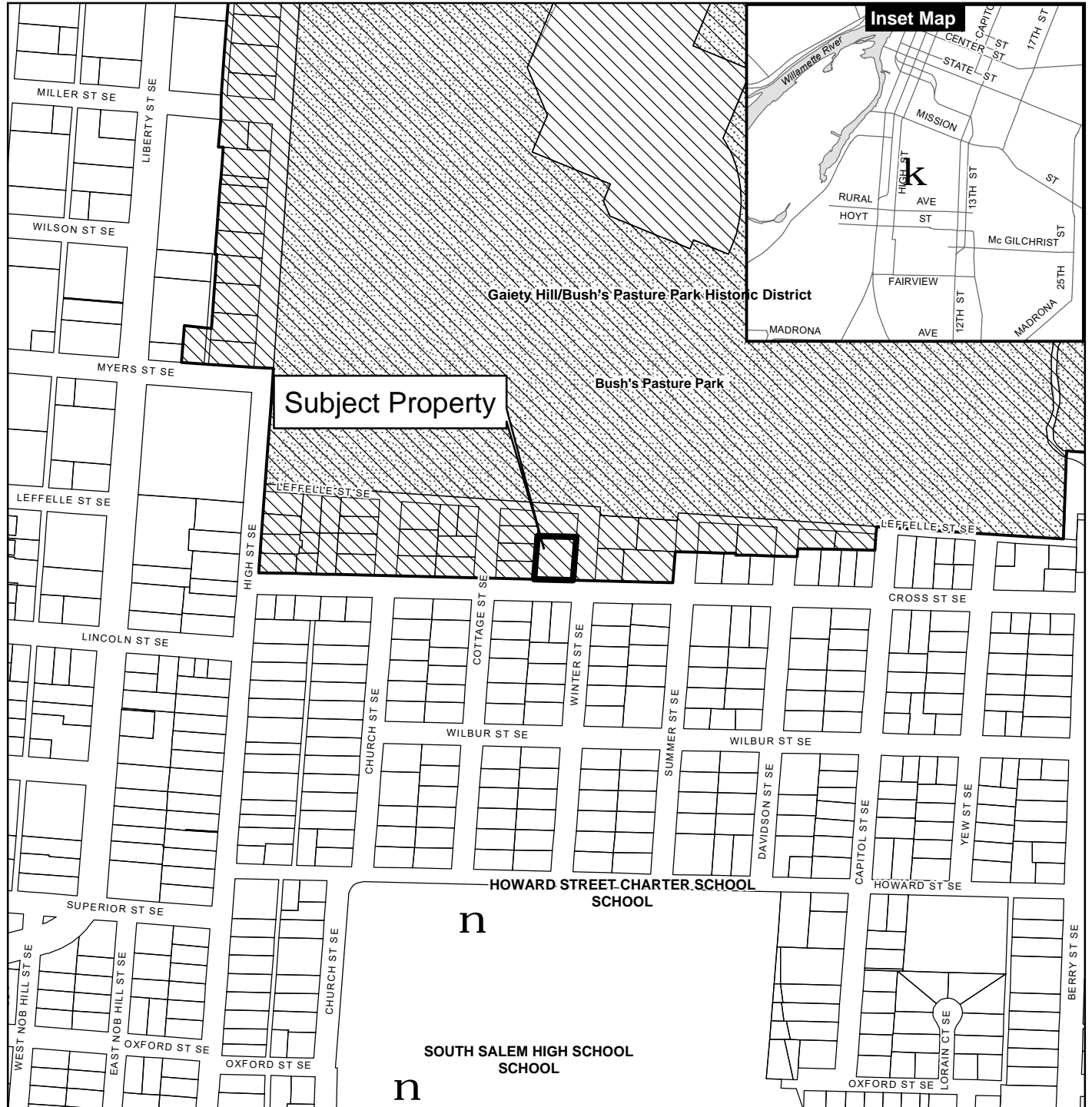

It is the City of Salem's policy to assure that no person shall be discriminated against on the grounds of race, religion, color, sex, marital status, familial status, national origin, age, mental or physical disability, sexual orientation, gender identity and source of income, as provided by Salem Revised Code Chapter 97. The City of Salem also fully complies with Title VI of the Civil Rights Act of 1964, and related statutes and regulations, in all programs and activities. Disability-related modification or accommodation, including auxiliary aids or services, in order to participate in this meeting or event, are available upon request. Sign language and interpreters for languages other than English are also available upon request. To request such an accommodation or interpretation, contact the Community Development Department at 503-588-6173 at least three business days before this meeting or event.

TTD/TTY telephone 503-588-6439 is also available 24/7

Vicinity Map 787 Cross St SE



Legend

-  Taxlots
-  Urban Growth Boundary
-  City Limits
-  Outside Salem City Limits
-  Parks
-  Historic District
-  Schools



This product is provided as is, without warranty. In no event is the City of Salem liable for damages from the use of this product. This product is subject to license and copyright limitations and further distribution or resale is prohibited.





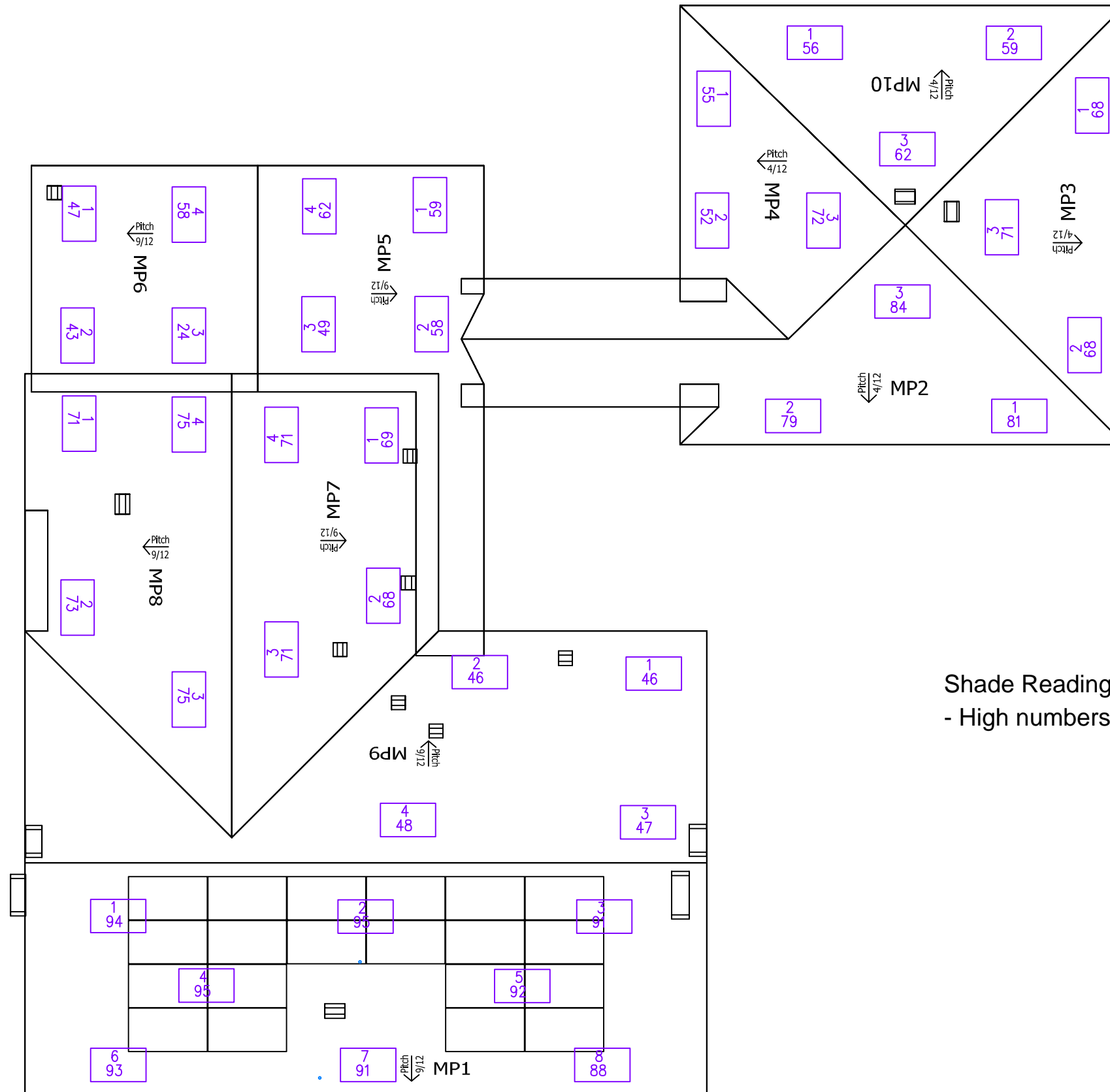

Shade Reading Analysis
 - High numbers indicate high sunlight

CONFIDENTIAL – THE INFORMATION HEREIN CONTAINED SHALL NOT BE USED FOR THE BENEFIT OF ANYONE EXCEPT TESLA INC., NOR SHALL IT BE DISCLOSED IN WHOLE OR IN PART TO OTHERS OUTSIDE THE RECIPIENT'S ORGANIZATION, EXCEPT IN CONNECTION WITH THE SALE AND USE OF THE RESPECTIVE TESLA EQUIPMENT, WITHOUT THE WRITTEN PERMISSION OF TESLA INC.

JOB NUMBER: JB-9731311 00

MOUNTING SYSTEM:
 ZS Comp V4 w Metal-Flashing

MODULES:
 (20) SolarCity Standard #SC325

INVERTER:
 SOLAREEDGE # SE7600H-US000SNU2

CUSTOMER:
 Jessica Maxwell
 787 Cross St SE
 Salem, OR 97302

(503) 881-7311

DESCRIPTION:
 6.5 KW PV ARRAY
 27 KWH ENERGY STORAGE SYSTEM

PAGE NAME:
 STRING DIAGRAM

DESIGN:
 Sierra Wilen

SHEET: SC 6 REV: DATE: 8/15/2019

